

The Camden (Neighbourhoods of the Future) Experimental Traffic Order 2020

Notice is hereby given that the Council of the London Borough of Camden made the above mentioned order on 24 August 2020 under Section 9 of the Road Traffic Regulation Act 1984, as amended. The order will come into force on 14 September 2020. The general nature and effect of the order is as follows:

Motor vehicles will be prohibited from entering the roads below at the locations specified on Mondays to Fridays between 8 and 9am and between 3 and 4.15pm:

Nutley Terrace, west of its junction with Fitzjohn's Avenue

Netherhall Gardens, at its junction with Fitzjohn's Avenue

Frognal, north of its junction with Hampstead Gate.

Frognal, south of its junction with Arkwright Road

Exemptions will apply to vehicles registered to addresses in Netherhall Gardens, Maresfield Gardens, Nutley Terrace (between its junctions with Fitzjohn's Avenue and Netherhall Gardens and Frognal (between its junctions with Hampstead Gate and Arkwright Road) and any properties which can only be accessed by way of these streets (or sections of streets), to Disabled Persons' Badge holders living at any of these addresses, vehicles being used to transport a person issued with a Disabled Persons' Badge to premises in these streets (or sections of streets), vehicles which are exclusively electrically powered (i.e. not hybrid vehicles), zero-emission capable taxis, school buses serving any of the schools in Netherhall Gardens or vehicles being used to transport students with disabilities to and from these schools.

The Council will be considering in due course whether the provisions of the experimental order should be continued in force indefinitely. Within a period of six months beginning with the date on which the experimental order came into force or, if the order is varied by other orders or modified pursuant to section 10 (2) of the Road Traffic Regulation Act 1984, beginning with the day on which the variation or modification or the latest variation or modification came into force, any person may object to the making of an order for the purpose of such indefinite continuation.

Any such objection must be made in writing, stating the grounds on which the objection is being made and sent to safetravel@camden.gov.uk or by post to London Borough of Camden, Culture Environment & Directorate, Transport Strategy Service, FREEPOST RSLT-RJBR-TXAA, London, WC1H 9JE. Copies of the orders and other documents related to these schemes may be inspected at camden.gov.uk/recently-advertised-proposals or by contacting traffic.orders@camden.gov.uk or at London Borough of Camden, 5 Pancras Square, N1C 4AG.

Peter Mardell
Head of Parking Operations
27 August 2020

The Camden (Neighbourhoods of the Future) Experimental Traffic Order 2020

STATEMENT OF REASONS

The measures will implement a Healthy School Street (HSS) zone around five schools. The timed road closures would incorporate Maresfield Gardens, Netherhall Gardens, Nutley Terrace, and Netherhall Way. The HSS scheme contributes to the delivery of Our Camden Plan by making it easier for people to walk and cycle. Additionally it contributes to one of the Camden Climate Citizens' Assembly recommendations of more car free zones in the borough.

The scheme incorporates several roads and school sites and is part of the Neighbourhoods of the Future Project, which is funded by Transport for London and London Councils.

The Camden (Neighbourhoods of the Future) Experimental Traffic Order 2020

REASONS FOR PROCEEDING BY WAY OF AN EXPERIMENT

At the present time, restrictions on people's movements as a result of the Covid-19 crisis may render normal modes of consultation ineffective. Additionally, the current state of traffic on the affected streets may not reflect the ordinary operation of the schemes which may prevent consultees from forming a reasoned opinion over their effect.

The experimental order will be in force for a maximum period of 18 months and the council will decide whether or not to retain the schemes indefinitely before the expiration of this period. The council is required to consider any objections made over the initial 6 month period. It is anticipated that the various schemes may have a longer-term utility and their operation will be evaluated whilst the experimental orders remain in force. Council officers would ideally wish to carry out a full consultation on each scheme after 12 months to elicit views from stakeholders and members of the public, subject to circumstances. A decision as to whether to do so or not will be made nearer the time.

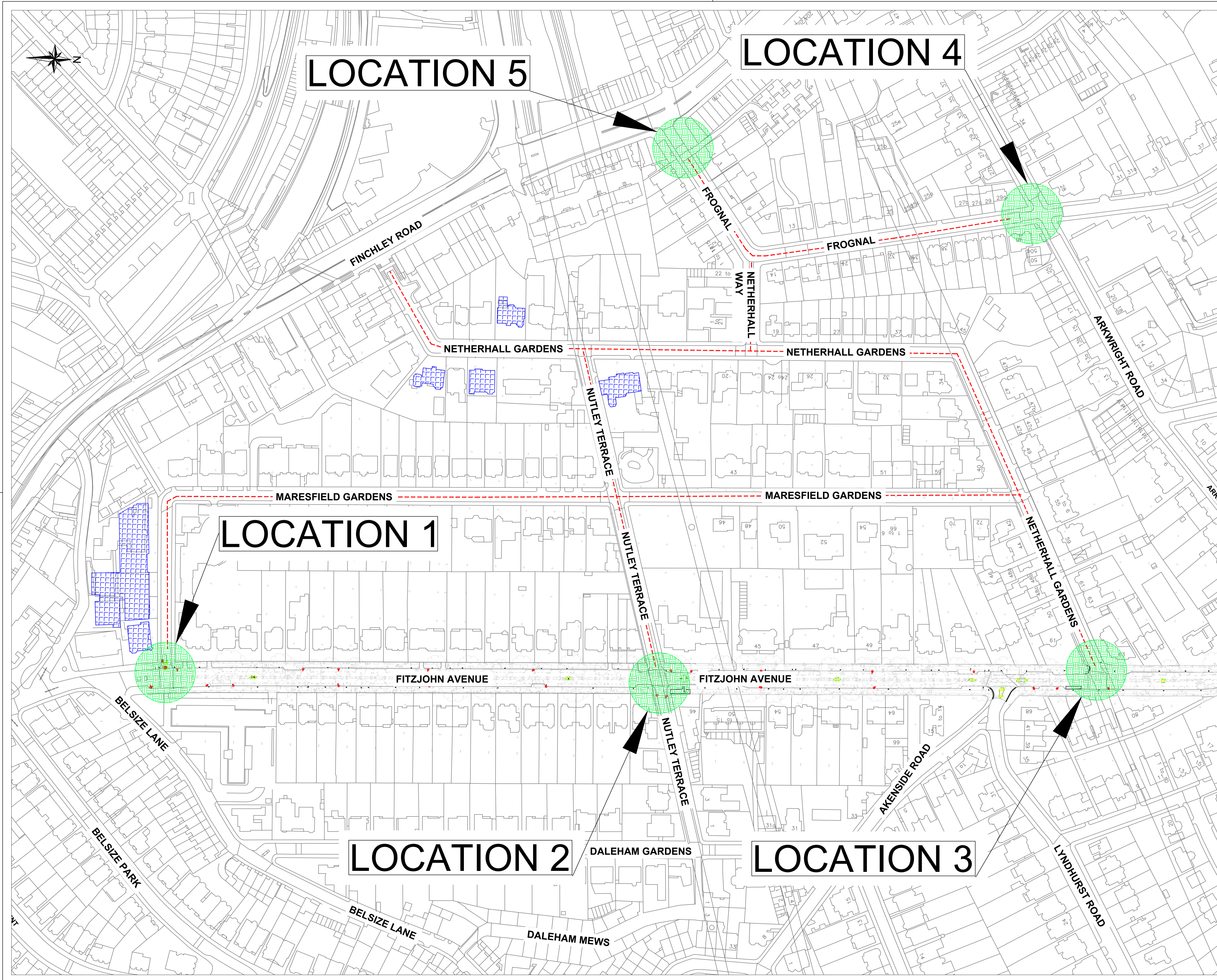

NOTES

1. DO NOT SCALE FROM THE DRAWING.
2. ALL DIMENSIONS IN METRES UNLESS STATED OTHERWISE.
3. DRAWING TO BE READ IN CONJUNCTION WITH
NOF-HSS-05-TMO-0100-1001
NOF-HSS-05-TMO-0100-1002

Rev	By	Date	Amendments
A	HD	19.08.20	Initial Issue



Design Team
 Transport Strategy Service
 London Borough of Camden
 5 Pancras Square
 Tel 020 7974 5551, Fax 020 7974 6952
 DX 2106 Euston, Minicom 020 7974 6866

Project
 NEIGHBOURHOODS
 OF THE FUTURE
 HEALTHY SCHOOL STREETS SCHEME

Drawing Title
 NETHERHALL GARDENS - HSS 05
 TRAFFIC MANAGEMENT ORDER
 SHEET 1 OF 2

Scale NTS	Date AUG 2020
Drawn By HD	File Ref NOF-HSS-05
Checked By HD	Dwg Name NOF-HSS-05.dwg

Drawing Location
 T:\Cptl_Schms\2019-19\C & NF\Fitzjohns Avenue\08_Drawings\04 - Detail Design
 Drawing Number
 NOF-HSS-05-TMO-0100-1001

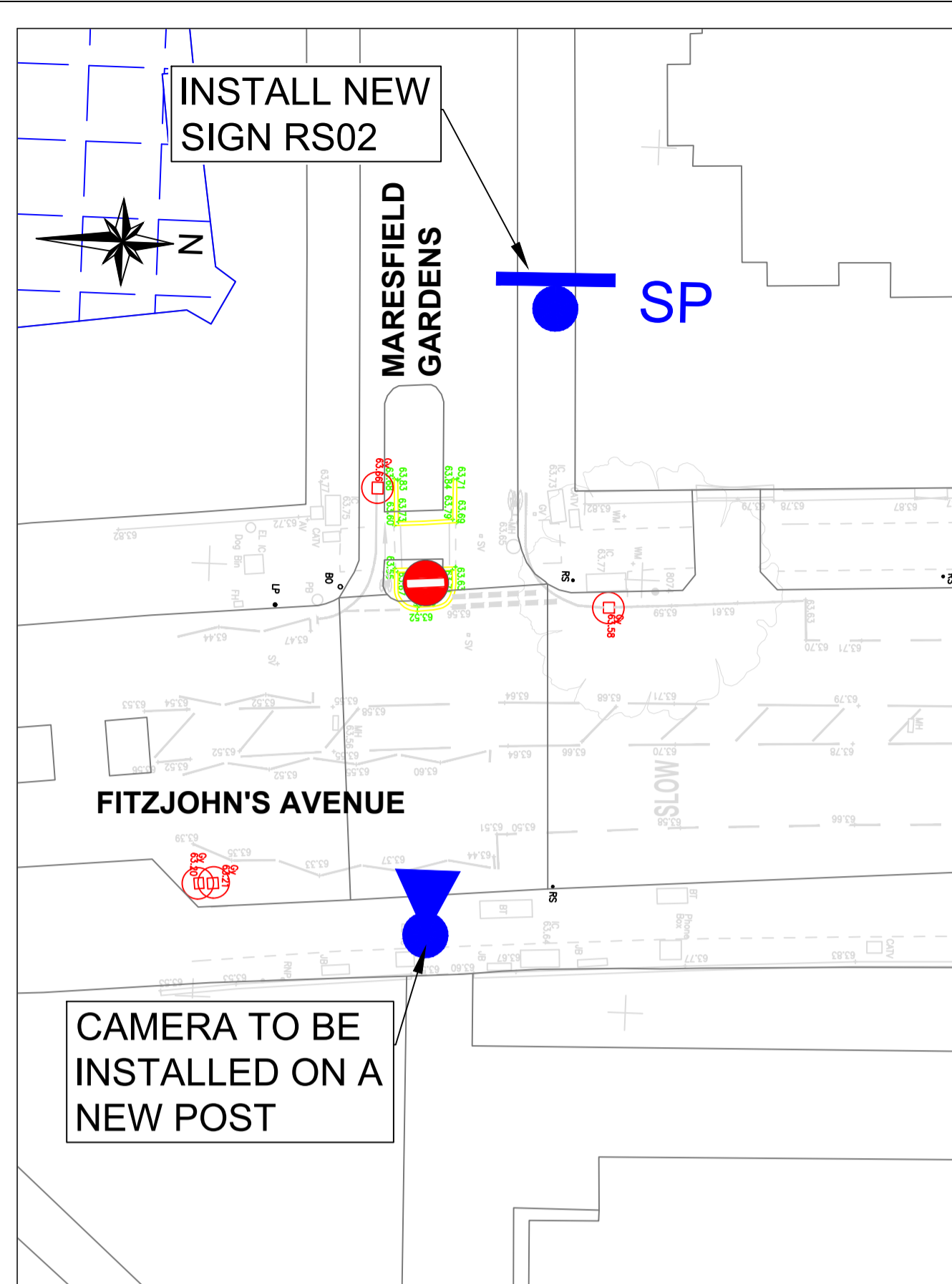

**PROPOSED LAYOUT
LOCATION 1**

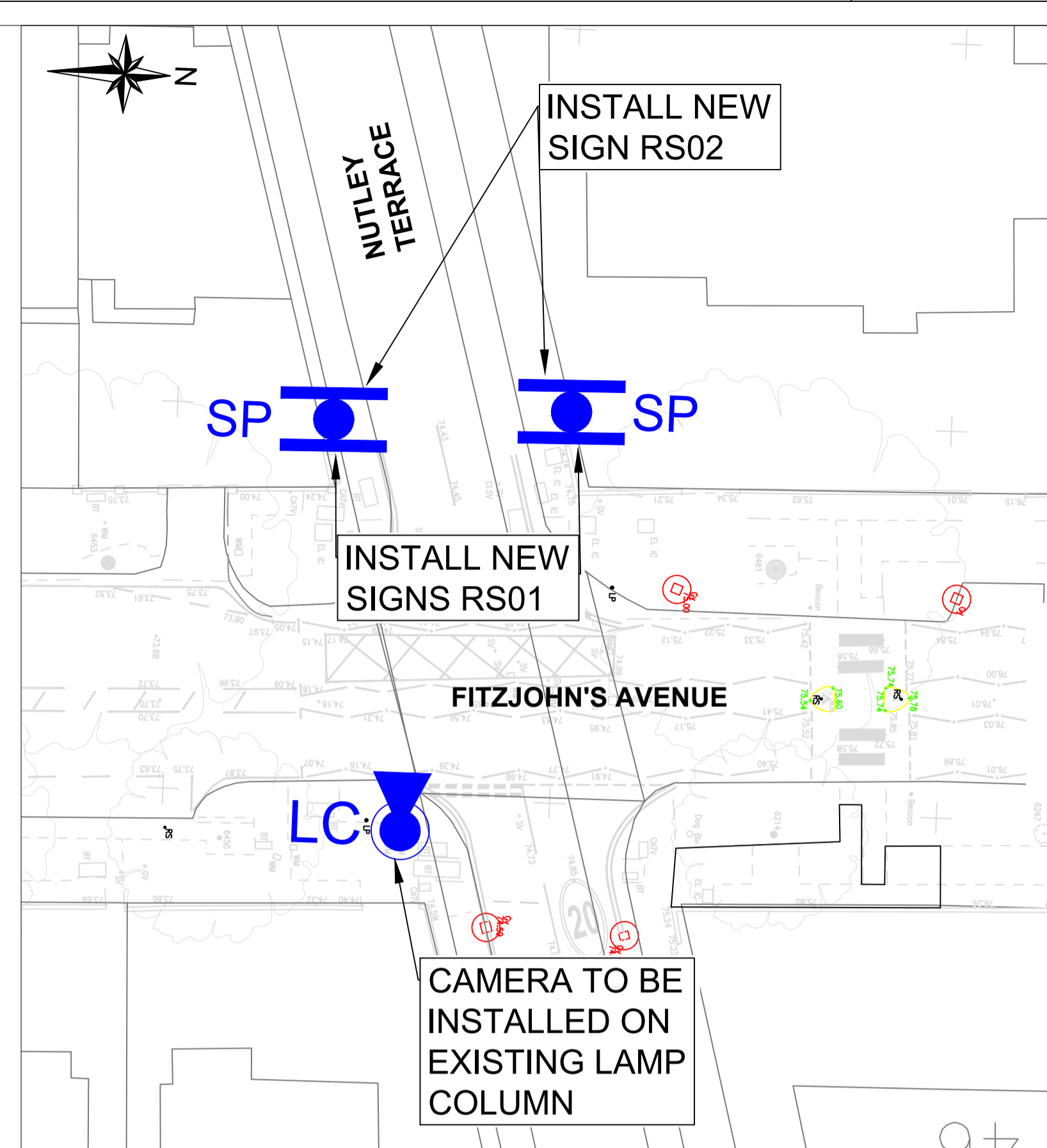

**PROPOSED LAYOUT
LOCATION 2**

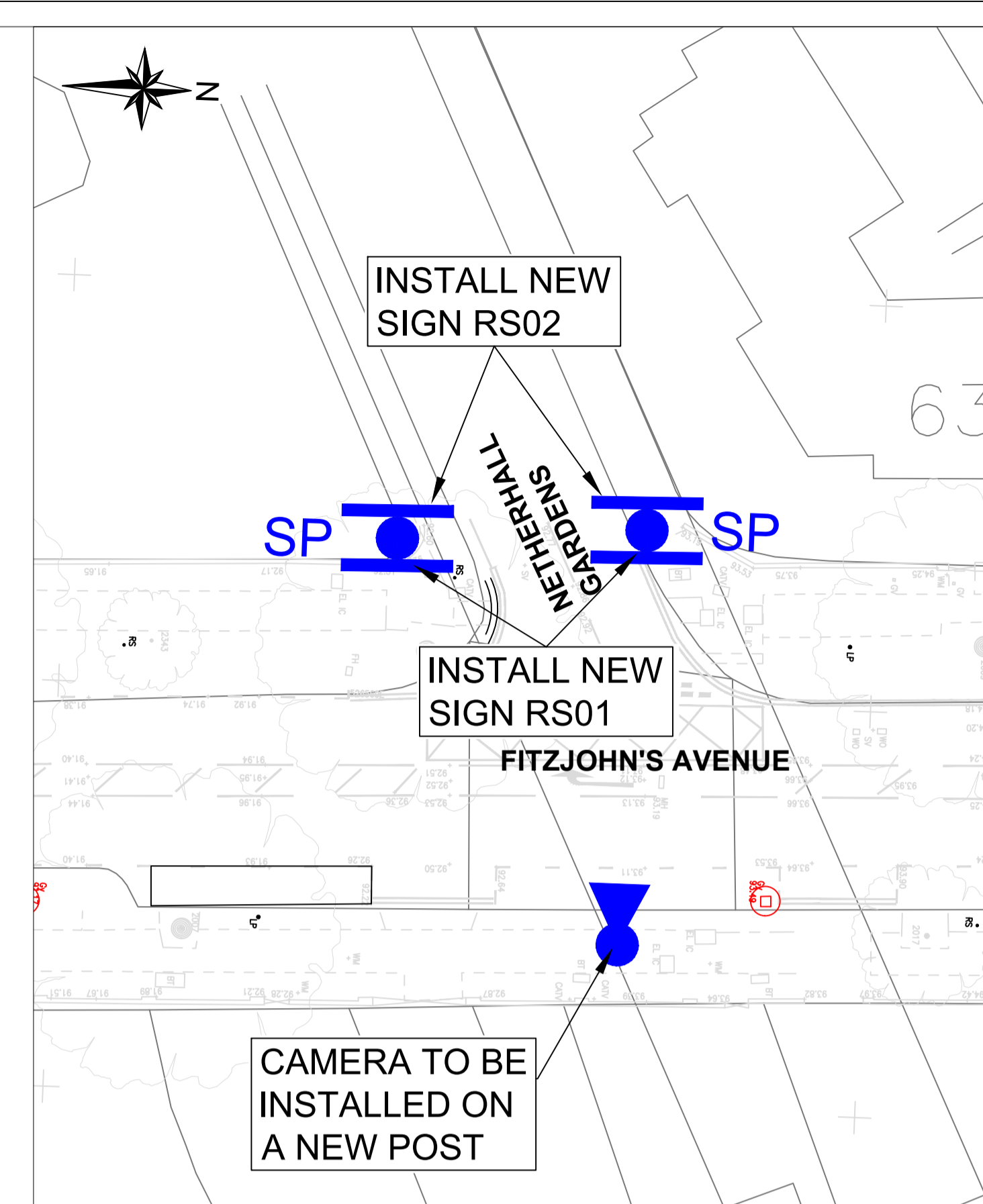

**PROPOSED LAYOUT
LOCATION 3**

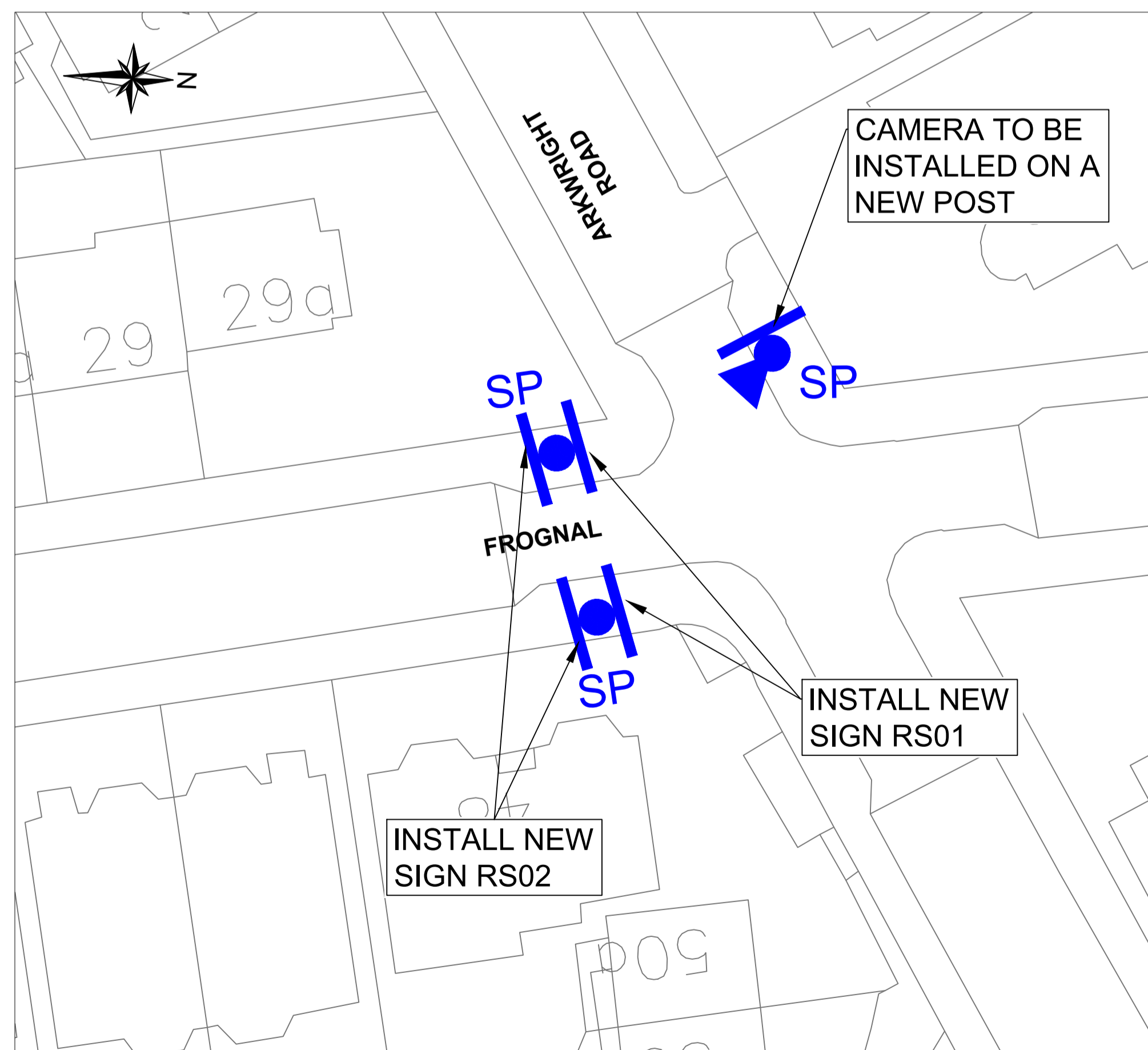

**PROPOSED LAYOUT
LOCATION 4**

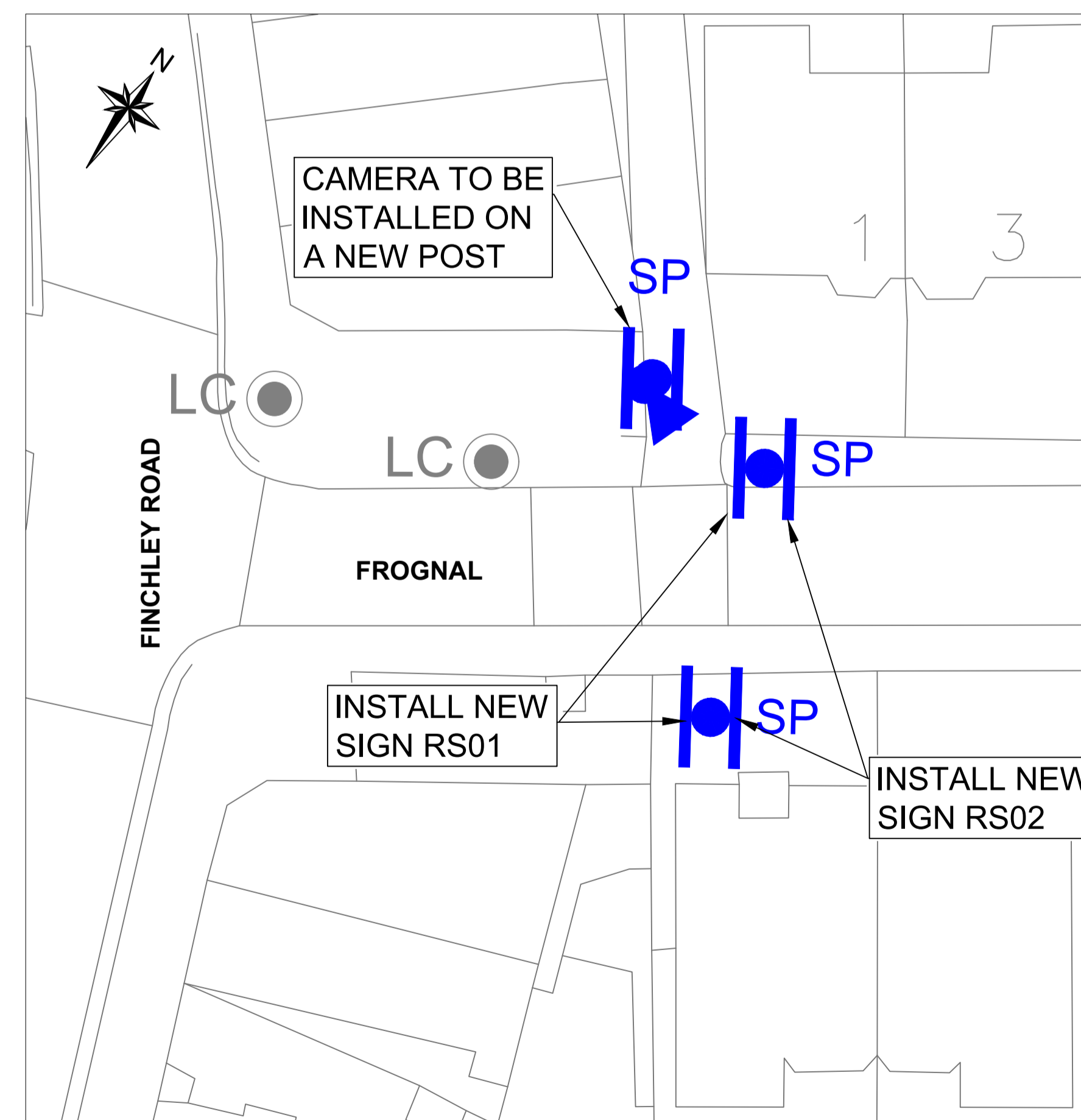

**PROPOSED LAYOUT
LOCATION 5**

- LEGEND**
- SP SIGN
 - CAMERA
 - SIGN NO.
 - SCHOOL LOCATION
 - EXISTING LAMP COLUMN
 - EXISTING LAMP COLUMN TO HOLD CAMERA

- NOTES**
1. DO NOT SCALE FROM THE DRAWING.
 2. ALL DIMENSIONS IN METRES UNLESS STATED OTHERWISE.
 3. DRAWING TO BE READ IN CONJUNCTION WITH
NOF-HSS-05-TMO-0100-1001
NOF-HSS-05-TMO-0100-1002

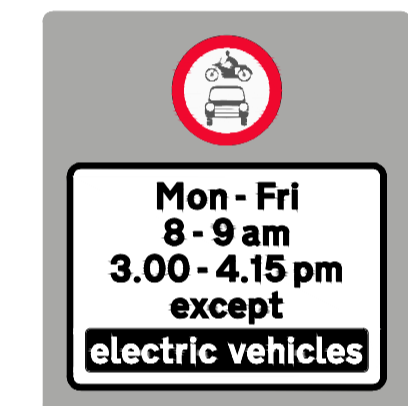

RS01

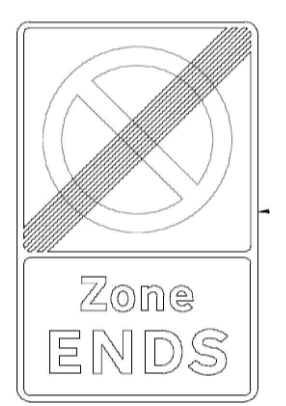

RS02

Rev	By	Date	Amendments
A	HD	19.08.20	Initial Issue



Design Team
Transport Strategy Service
London Borough of Camden
5 Pancras Square
Tel 020 7974 5551, Fax 020 7974 6952
DX 2106 Euston, Minicom 020 7974 6866

Project
**NEIGHBOURHOODS
OF THE FUTURE
HEALTHY SCHOOL STREETS SCHEME**

Drawing Title
**NETHERHALL GARDENS - HSS 05
TRAFFIC MANAGEMENT ORDER
SHEET 2 OF 2**

Scale NTS	Date AUG 2020
Drawn By HD	File Ref NOF-HSS-05
Checked By HD	Dwg Name NOF-HSS-05.dwg

Drawing Location
T:\Cptl_Schms\2018-19\C & NF\Fitzjohns Avenue\08_Drawings\04 - Detail Design
Drawing Number
NOF-HSS-05-TMO-0100-1002

Rev.
A

The Camden (Neighbourhoods of the Future) Experimental Traffic Order 2020

2020 No. 58

LONDON BOROUGH OF CAMDEN

TRAFFIC MANAGEMENT ORDER

2020 No. 58

The Camden (Neighbourhoods of the Future) Experimental Traffic Order 2020

Made on 24 August 2020

Coming into force on 14 September 2020

The Council of the London Borough of Camden, after consulting the Commissioner of Police of the Metropolis, in exercise of the powers conferred by section 9 of Road Traffic Regulation Act 1984 [1984 c. 27], and of all other powers thereunto enabling, hereby make the following order:

1. Citation and commencement

- 1.1 This order shall come into force on 14 September 2020 and may be cited as the Camden (Neighbourhoods of the Future) Experimental Traffic Order 2020.

2. Interpretation

- 2.1 In this order the following terms have the meanings ascribed to them.

"pedal cycle" has the same meaning as ascribed to it by the Traffic Signs Regulations and General Directions 2016 [S. I. 2016 No. 362].

"electric vehicle" means a vehicle in which the electrical motive power is derived from an electrical storage battery which is not connected to any source of power when the vehicle is in motion;

"zero emissions capable taxi" means a taxi licenced by Transport for London and which must emit no more than 50g/km CO₂ exhaust emissions and be capable of being operated with no exhaust emissions for a minimum range of 10 miles, or, emit no more than 75g/km CO₂ exhaust emissions and be capable of being operated with no exhaust emissions for a minimum range of 20 miles;

"permitted address" means the address of any property or premises in Netherhall Gardens, Netherhall Way, Maresfield Gardens, Nutley Terrace west of its junction with Fitzjohn's Avenue and Frognaal between its junctions with Hampstead Gate and Arkwright Road and including any properties or premises which can only be accessed via these streets or sections of streets;

"school bus" means a motor vehicle constructed or adapted to carry more than 8 passengers (exclusive of the driver) and which is being used exclusively to transport students of any school in Netherhall Gardens to or from that school;

- 2.2 Any reference in this order to any enactment shall be construed as a reference to that enactment as amended, applied, consolidated, re-enacted by or as having effect by virtue of any subsequent enactment.

3. Restrictions

- 3.1 No person shall cause any vehicle to enter Netherhall Gardens at its junction with Fitzjohn's Avenue on Mondays to Fridays between 8 and 9am and between 3 and 4.15pm
- 3.2 No person shall cause any vehicle to enter the section of Nutley Terrace which lies west of its junction with Fitzjohn's Avenue, at its junction with Fitzjohn's Avenue, on Mondays to Fridays between 8 and 9am and between 3 and 4.15pm.
- 3.3 No person shall cause any vehicle to enter that section of Frognaal which lies between its junctions with Hampstead Gate and Arkwright Road on Mondays to Fridays between 8 and 9am and between 3 and 4.15pm.

4. Exemptions

- 4.1 Nothing in Article 3 shall apply in respect of;
- 4.1.1 a pedal cycle;
- 4.1.2 anything done with the permission or at the direction of a police constable or traffic warden in uniform;
- 4.1.3 a vehicle being used by the police, fire brigade or ambulance service in an emergency;
- 4.1.4 a vehicle being used by the council in the pursuance of statutory purposes;
- 4.1.5 any person who causes any vehicle to proceed in accordance with any restriction or requirement indicated by traffic signs placed pursuant to Section 66 or 67 of the Road Traffic Regulation Act 1984;
- 4.1.6 any vehicle registered to a permitted address;
- 4.1.7 any vehicle being used to transport a person resident at a permitted address and to whom a valid disabled persons' badge has been issued;
- 4.1.8 a zero emissions capable taxi;
- 4.1.9 a school bus;
- 4.1.10 any vehicle which may otherwise be authorised by the council.

5. Power to modify or amend this order

- 5.1 Pursuant to Section 10 (2) of the Act of 1984, the Director of Regeneration & Planning, Supporting Communities Directorate, or any person authorised by him may, if it appears to him or such other authorised person essential in the interest of the expeditious, convenient and safe movement of traffic, or in the provision of suitable and adequate parking, or for preserving or improving the amenities of the area through which any road affected by this order runs, modify or suspend this order or any of the provisions in this order.

Dated this 24 August 2020



**Peter Mardell
Head of Parking Operations**

