

The Camden (Prescribed Routes) Experimental Traffic Order (No. 9) 2020

Notice is hereby given that the Council of the London Borough of Camden made the above mentioned Experimental Traffic Order on 22 June 2020 under Section 9 of the Road Traffic Regulation Act 1984, as amended. The order will come into force on 2 July 2020. The general nature and effect of the order is as follows.

PRINCE OF WALES ROAD, NW1

In order to facilitate the construction of an eastbound cycle lane, all parking places on the north side of the carriageway will be removed between Haverstock Hill and Grafton Road. Eleven "CA-F" permit holders parking places are situated along this stretch of the road with a total length of approximately 290 metres. A motorcycle parking place, car club parking place, loading bay and a paid-for parking place would also be removed. The order also designates a prohibition on waiting by vehicles at any time along the same length of the road.

The Council will be considering in due course whether the provisions of the experimental order should be continued in force indefinitely. Within a period of six months beginning with the date on which the experimental order comes into force or, if the orders are varied by other orders or modified pursuant to section 10 (2) of the Road Traffic Regulation Act 1984, beginning with the day on which the variation or modification or the latest variation or modification came into force, any person may object to the making of an order for the purpose of such indefinite continuation.

Any such objection must be made in writing, stating the grounds on which the objection is being made and sent to safetravel@camden.gov.uk or by post to London Borough of Camden, Culture Environment & Directorate, Transport Strategy Service, FREEPOST RSLT-RJBR-TXAA, London, WC1H 9JE. Copies of the orders and other documents related to these schemes may be inspected at camden.gov.uk/recently-advertised-proposals or by contacting traffic.orders@camden.gov.uk or at London Borough of Camden, 5 Pancras Square, N1C 4AG.

Notice is also given under s.23 of the Road Traffic Regulation Act 1984 of the council's intent to convert two existing pedestrian crossings on Prince of Wales Road, east of Truro Street and west of Castle Mews, to "parallel crossings" with a crossing point for cyclists to be provided adjacent to the pedestrian crossing point.

Peter Mardell
Head of Parking Operations
25 June 2020

The Camden (Prescribed Routes) Experimental Traffic Order (No. 9) 2020

STATEMENT OF REASONS

The measures seek to respond to the safe travel and transport needs of people in Camden in light of Covid-19 by enabling them to travel more safely whilst avoiding public transport as lockdown eases in the coming weeks and months.

In anticipation of an increase in cycling, parking places will be removed on an experimental basis from the north side of Prince of Wales Road, between Haverstock Hill and Grafton Road in order to construct an eastbound cycle lane protected by flexible wands and a general prohibition on waiting by vehicles at any time will apply along the same length of road.

At bus stops we would install a mixture of bus stop bypasses and shared use bus stops. Existing zebra crossings will be converted to 'Parallel zebras' which would allow cyclists to use them and we would make small changes to islands at pedestrian crossings to allow for the eastbound cycle lane.

The Camden (Prescribed Routes) Experimental Traffic Order (No. 9) 2020

REASONS FOR PROCEEDING BY WAY OF AN EXPERIMENT

At the present time, restrictions on people's movements as a result of the Covid-19 crisis may render normal modes of consultation ineffective. Additionally, the current state of traffic on the affected streets may not reflect the ordinary operation of the scheme which may prevent consultees from forming a reasoned opinion over their effect.

The experimental order will be in force for a maximum period of 18 months and the council will decide whether or not to retain the scheme indefinitely before the expiration of this period. The council is required to consider any objections made over the initial 6 month period. It is anticipated that the scheme may have a longer-term utility and its operation will be evaluated whilst the experimental orders remain in force. Council officers would ideally wish to carry out a full consultation on each scheme after 12 months to elicit views from stakeholders and members of the public.

The Camden (Prescribed Routes) Experimental Traffic Order (No. 9) 2020

2020 No. 39

PRINCE OF WALES ROAD

LONDON BOROUGH OF CAMDEN

TRAFFIC MANAGEMENT ORDER

2020 No. 39

The Camden (Prescribed Routes) (No. 9) Experimental Traffic Order 2020

Made on 22 June 2020

Coming into force on 2 July 2020

The Council of the London Borough of Camden, after consulting the Commissioner of Police of the Metropolis, in exercise of the powers conferred by section 9 of Road Traffic Regulation Act 1984 [1984 c. 27], and of all other powers thereunto enabling, hereby make the following order:

1. Citation and commencement

- 1.1 This order shall come into force on 2 July 2020 and may be cited as the Camden (Prescribed Routes) (No. 9) Experimental Traffic Order 2020.

2. Interpretation

- 2.1 Any reference in this order to any enactment shall be construed as a reference to that enactment as amended, applied, consolidated, re-enacted by or as having effect by virtue of any subsequent enactment.

3. Revocation of Parking Places and Amendments to Waiting Restrictions

- 3.1 For as long as this order remains in force;
- 3.1.1 the Camden (Parking Places) (CA-F) Traffic Order 2012 [L.B.C. 2012 No. 6] shall have effect as though there were omitted from schedule 1 to that order, the items set out in table 1.1 of the schedule to this order, and as though there was omitted from schedule 2 to that order, the item set out in table 1.2 of the schedule to this order;
- 3.1.2 the Camden (Parking Places) (Car Clubs) Traffic Order 2012 [L.B.C. 2012 No. 26] shall have effect as though there was omitted from the schedule to that order, the item set out in table 2 of the schedule to this order;
- 3.1.3 the Camden (Loading Places) Traffic Order 2012 [L.B.C. 2012 No. 21] shall have effect as though there was omitted from the schedule to that order, the item set out in table 3 of the schedule to this order.

- 3.2 For as long as this order remains in force, the Camden (Waiting and Loading Restrictions) (Civil Enforcement Area) Traffic Order 2012 [L.B.C. 2012 No. 1] shall have effect as though;
- 3.2.1 there was omitted from schedule 5 to that order, the item set out in table 4 of the schedule to this order;
- 3.2.2 there was substituted for the items relating to Prince of Wales Road in Schedule 1 to that order, the items set out in table 5 of the schedule to this order.

4. Power to modify or amend this order

- 4.1 Pursuant to Section 10 (2) of the Act of 1984, the Director of Regeneration & Planning, Supporting Communities Directorate, or any person authorised by him may, if it appears to him or such other authorised person essential in the interest of the expeditious, convenient and safe movement of traffic, or in the provision of suitable and adequate parking, or for preserving or improving the amenities of the area through which any road affected by this order runs, modify or suspend this order or any of the provisions in this order.

Dated this 22 June 2020



Peter Mardell
Head of Parking Operations

SCHEDULE

TABLE 1.1 – ITEMS OMITTED FROM SCHEDULE 1 TO THE CAMDEN (PARKING PLACES) (CA-F) TRAFFIC ORDER 2012

ITEM NUMBER	STREET	LENGTH OF HIGHWAY	CONTROLLED HOURS
11729	PRINCE OF WALES ROAD	north side: from a point opposite the common boundary of nos. 171 and 173 Prince of Wales Road, westwards for a distance of 24.15 metres	MONDAY – FRIDAY 8.30AM – 11PM SATURDAY & SUNDAY 9.30AM – 11PM
11740	PRINCE OF WALES ROAD	north side: from a point 3 metres east of a point opposite the eastern kerb line of Craddock Street, eastwards for a distance of 12 metres	MONDAY – FRIDAY 8.30AM – 11PM SATURDAY & SUNDAY 9.30AM – 11PM
11741	PRINCE OF WALES ROAD	north side: from a point 10.7 metres west of a point opposite the western kerb line of Truro Street, westwards for a distance of 15.6 metres	MONDAY – FRIDAY 8.30AM – 11PM SATURDAY & SUNDAY 9.30AM – 11PM
11742	PRINCE OF WALES ROAD	north side: from a point 5.2 metres west of the western kerb line of St. Silas Place, westwards for a distance of 28.2 metres	MONDAY – FRIDAY 8.30AM – 11PM SATURDAY & SUNDAY 9.30AM – 11PM
11739	PRINCE OF WALES ROAD	north side: from a point 17.9 metres east of the eastern kerb line of St. Silas Place, eastwards for a distance of 47.6 metres	MONDAY – FRIDAY 8.30AM – 11PM SATURDAY & SUNDAY 9.30AM – 11PM
11736	PRINCE OF WALES ROAD	north side: from a point 3.6 metres east of the party wall of nos. 120 and 122 Prince of Wales Road, eastwards for a distance of 7 metres	MONDAY – FRIDAY 8.30AM – 11PM SATURDAY & SUNDAY 9.30AM – 11PM
12204	PRINCE OF WALES ROAD	north side: from a point 1.8 metres east of the party wall of nos. 114 and 116 Prince of Wales Road, eastwards for a distance of 69 metres	MONDAY – FRIDAY 8.30AM – 11PM SATURDAY & SUNDAY 9.30AM – 11PM
11743	PRINCE OF WALES ROAD	north side: from a point 17.7 metres east of its junction with Talacre Road, eastwards for a distance of 11.9 metres	MONDAY – FRIDAY 8.30AM – 11PM SATURDAY & SUNDAY 9.30AM – 11PM

12133	PRINCE OF WALES ROAD	north side: from a point 29 metres east of the eastern kerb line of Dalby Street, eastwards for a distance of 30 metres	MONDAY – FRIDAY 8.30AM – 11PM SATURDAY & SUNDAY 9.30AM – 5.30PM
12132	PRINCE OF WALES ROAD	north side: from a point 8 metres west of the western kerb line of Ryland Road, westwards for a distance of 25 metres	MONDAY – FRIDAY 8.30AM – 11PM SATURDAY & SUNDAY 9.30AM – 5.30PM
12652	PRINCE OF WALES ROAD	north side: from a point 45 metres west of the western kerb line of Grafton Road, westwards for a distance of 25 metres	MONDAY – FRIDAY 8.30AM – 11PM SATURDAY & SUNDAY 9.30AM – 5.30PM

TABLE 1.2 – ITEM OMITTED FROM SCHEDULE 2 TO THE CAMDEN (PARKING PLACES) (CA-F) TRAFFIC ORDER 2012

ITEM NUMBER	STREET	LENGTH OF HIGHWAY	CONTROLLED HOURS	TARIFF (NON-DIESEL ENGINED)	TARIFF (DIESEL ENGINED)	MAXIMUM STAY
12134	PRINCE OF WALES ROAD	north side: from a point 26 metres west of the western kerb line of Grafton Road, westwards for a distance of 20 metres	MONDAY – FRIDAY 8.30AM - 6.30PM SATURDAY & SUNDAY 9.30AM – 5.30PM	£4.31 per hour	£5.24 per hour	2 hours

TABLE 2 – ITEM OMITTED FROM THE SCHEDULE TO THE CAMDEN (PARKING PLACES) (CAR CLUBS) TRAFFIC ORDER 2012

ITEM NUMBER	STREET	LENGTH OF HIGHWAY	DESIGNATION NUMBER
12016	PRINCE OF WALES ROAD	north side: from a point 7 metres east of a point in line with the eastern kerb line of Talacre Road, eastwards for a distance of 10 metres	CC137

TABLE 3 – ITEM OMITTED FROM THE SCHEDULE TO THE CAMDEN (LOADING PLACES) TRAFFIC ORDER 2012

ITEM NUMBER	STREET	LENGTH OF HIGHWAY	CONTROLLED HOURS
12370	PRINCE OF WALES ROAD	north side: from a point 4.1 metres west of the eastern perimeter fence of Talacre Open Space, westwards for a distance of 10 metres	MONDAY – FRIDAY 8.30AM – 11PM SATURDAY & SUNDAY 9.30AM – 5.30PM

TABLE 4 – ITEM OMITTED FROM SCHEDULE 5 TO THE CAMDEN (WAITING AND LOADING RESTRICTIONS) (CIVIL ENFORCEMENT AREA) TRAFFIC ORDER 2012

ITEM NUMBER	STREET	LENGTH OF HIGHWAY
11669	PRINCE OF WALES ROAD	north side: from a point 14.3 metres east of the party wall of nos. 120 and 122 Prince of Wales Road, eastwards for a distance of 10.4 metres and which has a width throughout of 2 metres.

TABLE 5 – ITEMS SUBSTITUTED FOR ITEMS RELATING TO PRINCE OF WALES ROAD IN SCHEDULE 1 TO THE CAMDEN (WAITING AND LOADING RESTRICTIONS) (CIVIL ENFORCEMENT AREA) TRAFFIC ORDER 2012

ITEM NUMBER	STREET – SIDE OF STREET – LENGTH OF HIGHWAY	RESTRICTED HOURS See Schedule
764	PRINCE OF WALES ROAD	
(a)	south side:	
(i)	from the junction with Haverstock Hill, eastward for a distance of 31 metres	A
(ii)	from the extended common boundary of nos. 189 and 191 Prince of Wales Road, westward for a distance of 9.5 metres	A
(iii)	from a point 2 metres west of the common boundary of nos. 177 and 179, eastward for a distance of 53.8 metres	A
(iv)	from a point 6 metres west of the western kerb line of Crogsland Road, eastward to a point 34 metres east of the north-eastern kerb line of Malden Crescent	A
(v)	from a point 36 metres west the western kerb-line of Harmood Street, westward for a distance of 16.2 metres.	A
(vi)	from a point 2.4 metres west of the western kerb line of Harmood Street, westward for a distance of 19.6 metres	A
(vii)	from a point 37.8 metres east of the eastern kerb line of Harmood Street to a point 17 metres west of the western kerb line of Hadley Street	A
(viii)	from a point 0.3 metres east of the extended common boundary of nos. 47 and 49 Prince of Wales Road, westward for a distance of 19.1 metres	A
(ix)	from the extended common boundary of nos. 39 and 41 Prince of Wales Road, westward for a distance of 14.5 metres	A
(x)	from the extended common boundary of nos. 39 and 41 Prince of Wales Road, eastward to a point 14.0 metres west of the party wall of no.15 Prince of Wales Road and nos.127/129 Castlehaven Road	3M

(xi)	from a point 14.0 metres west of the party wall of no.15 Prince of Wales Road and nos.127 / 129 Castlehaven Road to a point 8.9 metres east of the western flank wall of no.122 Castlehaven Road	A
(xii)	from a point 8.9 metres east of the western flank wall of no.122 Castlehaven Road to a point 15.3 metres west of the western kerb line of Kentish Town Road	2L
(xiii)	from the western kerb line of Kentish Town Road, westwards for a distance of 15.3 metres	A
(xiv)	so much of else of the south side of Prince of Wales Road that is public highway and lies west of the western limit of the Railway Bridge and which does not lie within those lengths specified above	3M
(xv)	so much else of the south side of Prince of Wales Road that is public highway and lies east of the of the western limit of the Railway Bridge and which does not lie within those lengths specified above	2L
(b)	north side:	
(i)	from the junction with Haverstock Hill to a point 52 metres east of the eastern kerb line of Grafton Road	A
(ii)	from a point 52 metres east of the eastern kerb line of Grafton Road, eastwards to a point 16.5 metres west of the western kerb line of Kentish Town Road	2L
(iii)	from the western kerb line of Kentish Town Road westwards for a distance of 16.5 metres	A

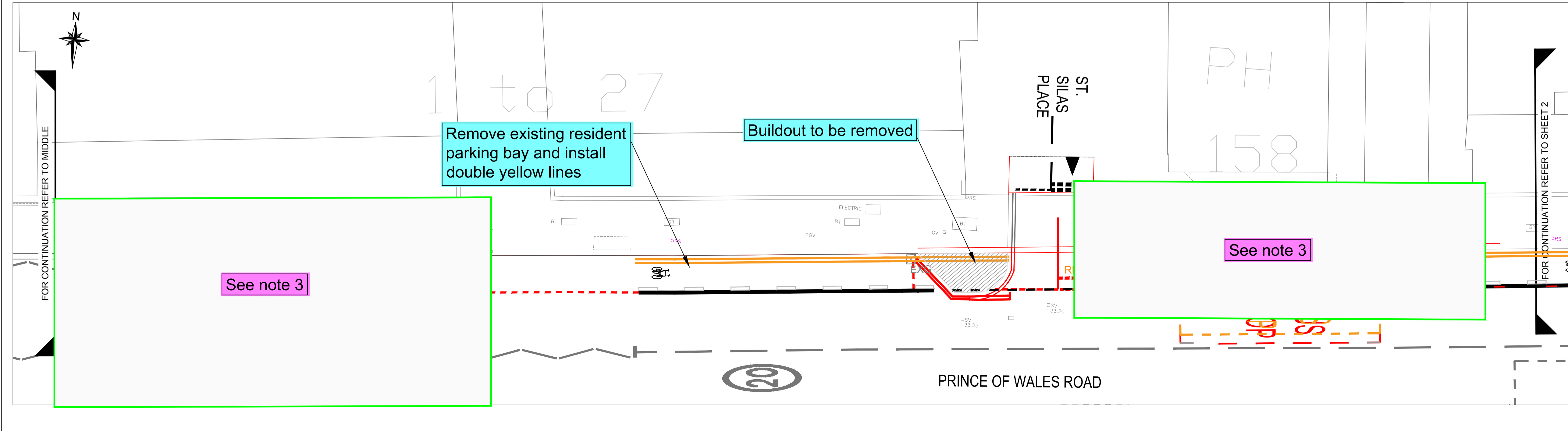
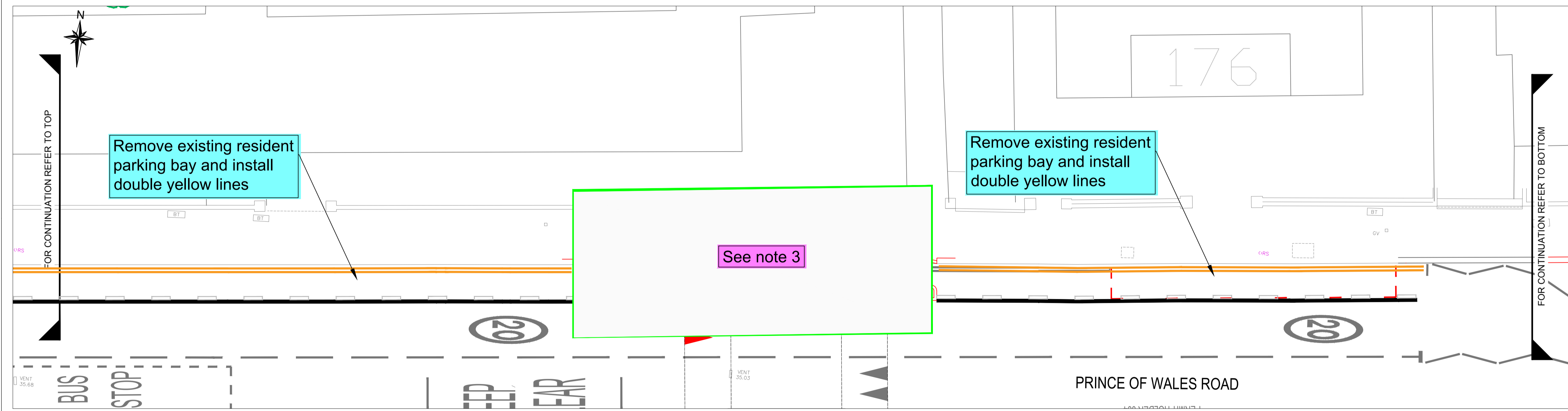
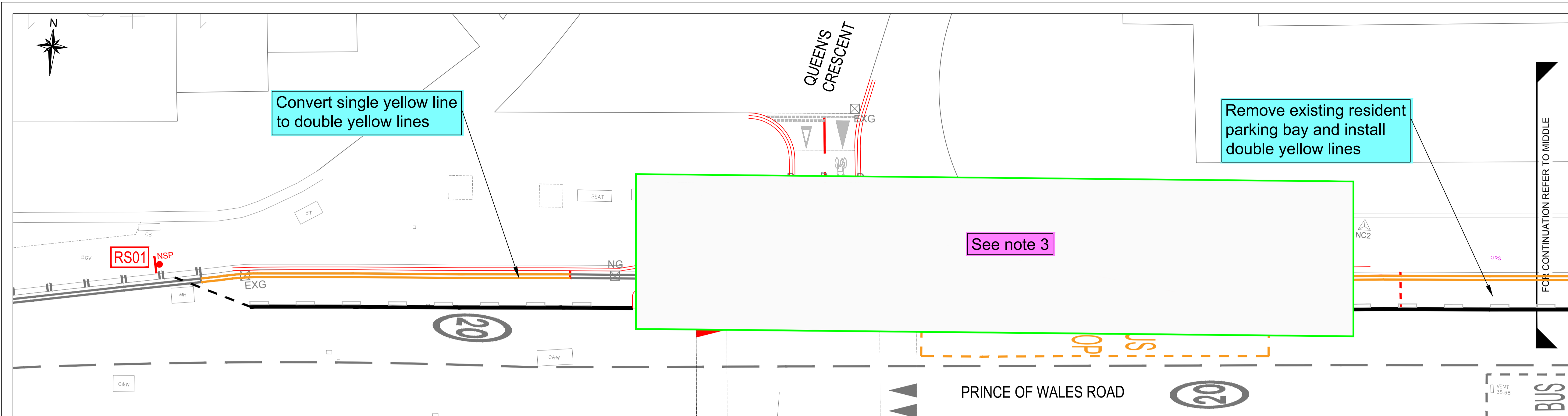

- LEGEND - PROPOSED WORKS**
- TWIN POST BLACK WAND ORCA WITH WHITE REFLECTIVE STRIPS AT 2.5m SPACING
 - NEW SIGN AND NEW POST
 - SIGN TO BE INSTALLED.
 - DOUBLE YELLOW LINE ROAD MARKINGS
 - WHITE ROAD MARKINGS
 - CYCLE LOGO ROAD MARKINGS
 - SETTING OUT LINE
 - SETTING OUT DIMENSIONS

- LEGEND - SITE CLEARANCE WORKS**
- REMOVE EXISTING ROAD MARKINGS

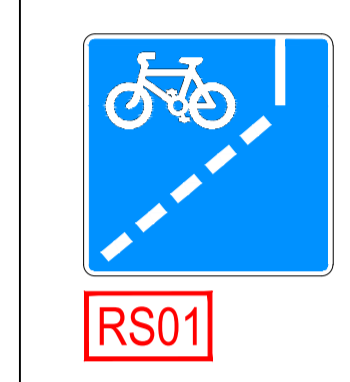

- NOTES**
1. DO NOT SCALE FROM THE DRAWING
 2. ALL DIMENSIONS IN METRES UNLESS STATED OTHERWISE
 3. THE EASTBOUND CYCLE TRACK FROM HAVERSTOCK HILL TO GRAFTON ROAD HAS BEEN COMPLETELY APPROVED, BUT WILL BE CONSTRUCTED IN PHASES.
- THIS IS PHASE 1 WHICH COVERS THE INTRODUCTION OF THE ROAD MARKINGS, SIGNS AND LIGHT SEGREGATION FEATURES IN THE FORM OF WANDS.
- THE OTHER PHASES WILL COVER WORKS TO THE THREE BUS STOP, TWO ZEBRA CROSSINGS AND ONE INFORMAL CROSSING POINT.

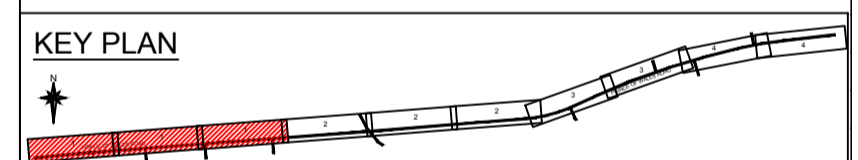

Rev	By	Date	Amendments
A	HD	22.06.20	TMO Issue

Camden
 Design Team
 Transport Strategy Service
 London Borough of Camden
 5 Pancras Square
 Tel 020 7974 5551, Fax 020 7974 6952
 DX 2106 Euston, Mincorn 020 7974 6866

PHASE 1	
Project PRINCE OF WALES ROAD POP UP CYCLING SCHEME COVID-19 TEMPORARY MEASURES	
Drawing Title EMERGENCY TRAFFIC MANAGEMENT ORDER SHEET 1 OF 4	
Scale NTS	Date JUN 2020
Drawn By HD	File Ref TM-COVID-POWR-PH1-DD
Checked By YK	Dwg Name TM-COVID-POWR-PH1-DD.dwg
Drawing Location T:\Cptl_Schms\2015-16_CN\Chalk Farm ABS\06 - Drawings\05\03 - Detail Design	
Drawing Number TM-COVID-POWR-PH1-DD-0100-1001	Rev. A

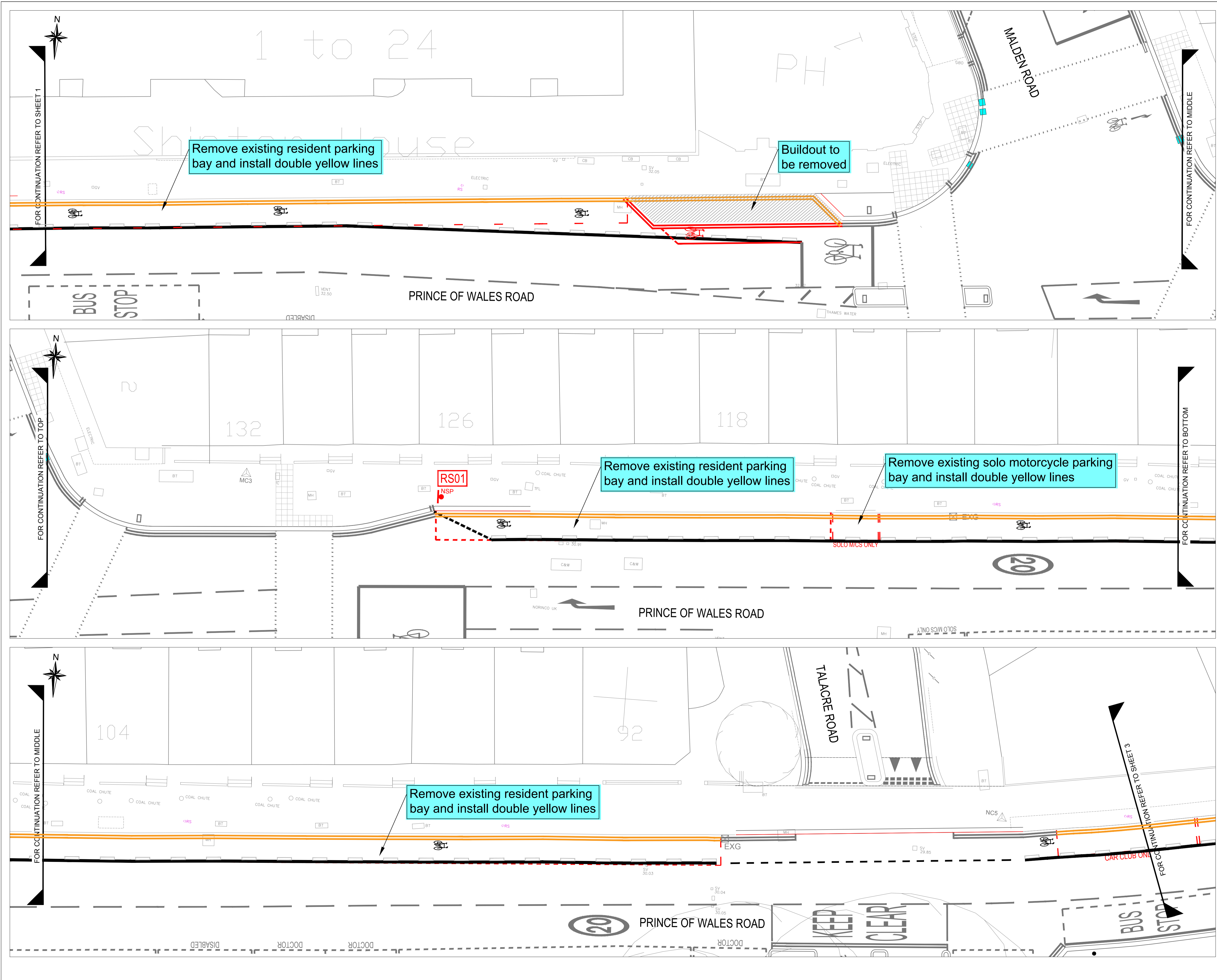

- LEGEND - PROPOSED WORKS**
- TWIN POST BLACK WAND ORCA WITH WHITE REFLECTIVE STRIPS AT 2.5m SPACING
 - NEW SIGN AND NEW POST
 - SIGN TO BE INSTALLED.
 - DOUBLE YELLOW LINE ROAD MARKINGS
 - WHITE ROAD MARKINGS
 - CYCLE LOGO ROAD MARKINGS
 - SETTING OUT LINE
 - SETTING OUT DIMENSIONS

- LEGEND - SITE CLEARANCE WORKS**
- REMOVE EXISTING ROAD MARKINGS



- NOTES**
1. DO NOT SCALE FROM THE DRAWING
 2. ALL DIMENSIONS IN METRES UNLESS STATED OTHERWISE
 3. THE EASTBOUND CYCLE TRACK FROM HAVERSTOCK HILL TO GRAFTON ROAD HAS BEEN COMPLETELY APPROVED, BUT WILL BE CONSTRUCTED IN PHASES.
- THIS IS PHASE 1 WHICH COVERS THE INTRODUCTION OF THE ROAD MARKINGS, SIGNS AND LIGHT SEGREGATION FEATURES IN THE FORM OF WANDS.
- THE OTHER PHASES WILL COVER WORKS TO THE THREE BUS STOP, TWO ZEBRA CROSSINGS AND ONE INFORMAL CROSSING POINT.

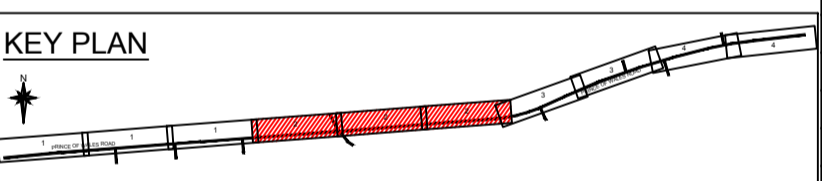

Rev	By	Date	Amendments
A	HD	22.06.20	TMO Issue

Camden
 Design Team
 Transport Strategy Service
 London Borough of Camden
 5 Pancras Square
 Tel 020 7974 5551, Fax 020 7974 6952
 DX 2106 Euston, Minicom 020 7974 6866

PHASE 1

Project: PRINCE OF WALES ROAD
 POP UP CYCLING SCHEME
 COVID-19 TEMPORARY MEASURES

Drawing Title: EMERGENCY
 TRAFFIC MANAGEMENT ORDER
 SHEET 2 OF 4

Scale: NTS	Date: JUN 2020
Drawn By: HD	File Ref: TM-COVID-POWR-PH1-DD
Checked By: YK	Dwg Name: TM-COVID-POWR-PH1-DD.dwg
Drawing Location: T:\Cptl_Schms\2015-16_CN\Chalk Farm ABS\06 - Drawings\05\03 - Detail Design	
Drawing Number: TM-COVID-POWR-PH1-DD-0100-1002	Rev: A

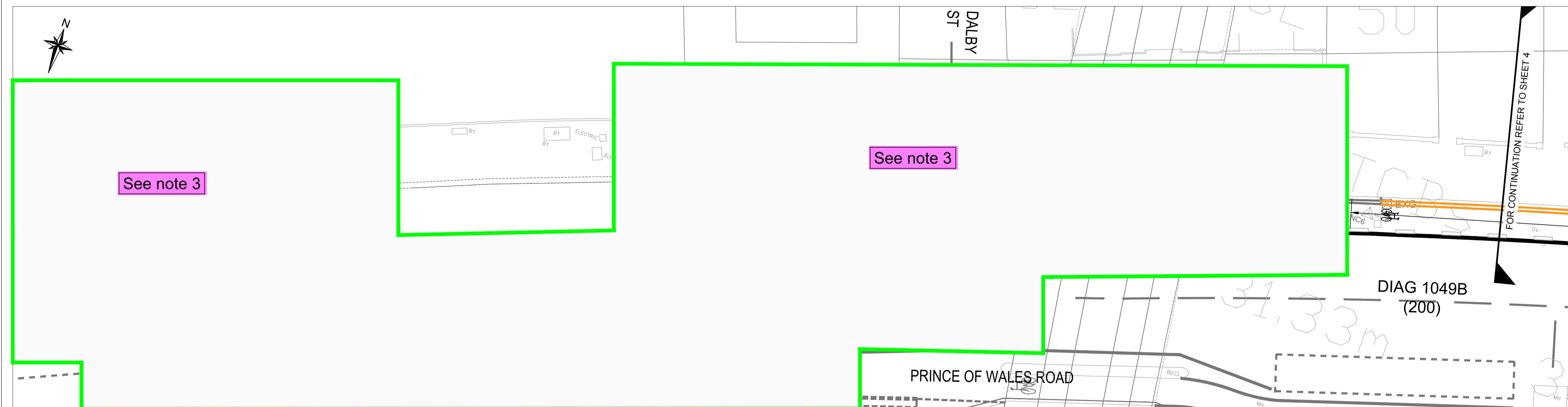
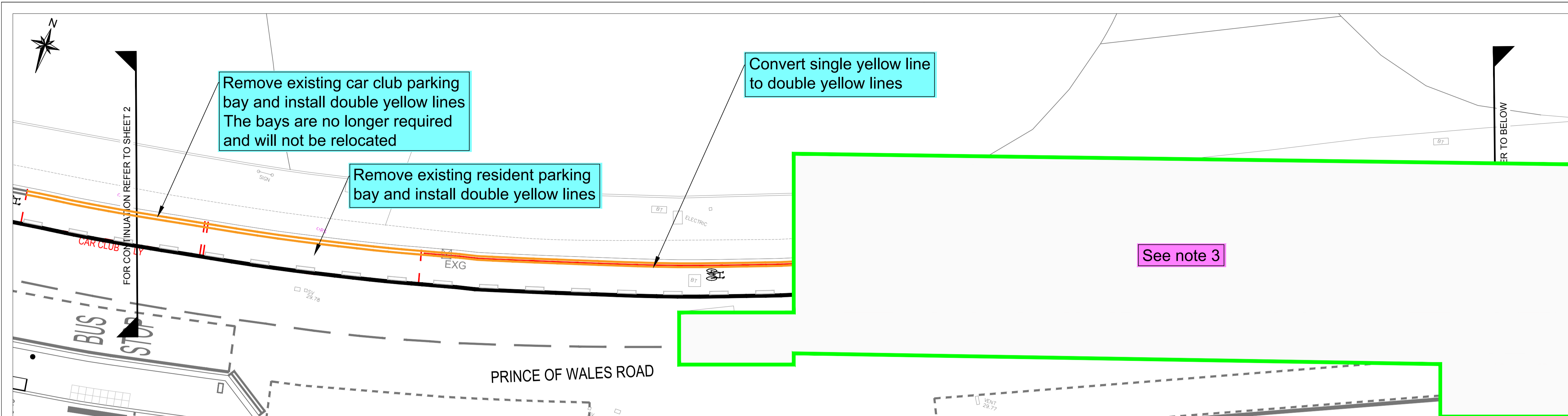

- LEGEND - PROPOSED WORKS**
- TWIN POST BLACK WAND ORCA WITH WHITE REFLECTIVE STRIPS AT 2.5m SPACING
 - NEW SIGN AND NEW POST
 - SIGN TO BE INSTALLED
 - DOUBLE YELLOW LINE ROAD MARKINGS
 - WHITE ROAD MARKINGS
 - CYCLE LOGO ROAD MARKINGS
 - SETTING OUT LINE
 - SETTING OUT DIMENSIONS
- LEGEND - SITE CLEARANCE WORKS**
- REMOVE EXISTING ROAD MARKINGS

- NOTES**
1. DO NOT SCALE FROM THE DRAWING
 2. ALL DIMENSIONS IN METRES UNLESS STATED OTHERWISE
 3. THE EASTBOUND CYCLE TRACK FROM HAVERSTOCK HILL TO GRAFTON ROAD HAS BEEN COMPLETELY APPROVED, BUT WILL BE CONSTRUCTED IN PHASES.
- THIS IS PHASE 1 WHICH COVERS THE INTRODUCTION OF THE ROAD MARKINGS, SIGNS AND LIGHT SEGREGATION FEATURES IN THE FORM OF WANDS.
- THE OTHER PHASES WILL COVER WORKS TO THE THREE BUS STOP, TWO ZEBRA CROSSINGS AND ONE INFORMAL CROSSING POINT.

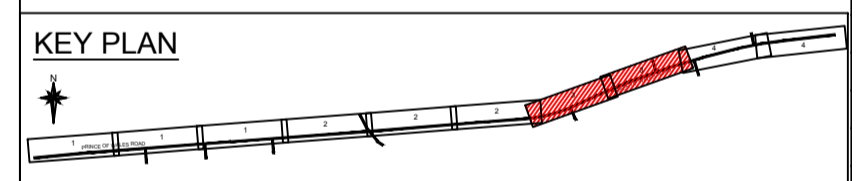

Rev	By	Date	Amendments
A	HD	22.06.20	TMO Issue

Camden
 Design Team
 Transport Strategy Service
 London Borough of Camden
 5 Pancras Square
 Tel 020 7974 5551, Fax 020 7974 6952
 DX 2106 Euston, Minicom 020 7974 6866

PHASE 1

Project
**PRINCE OF WALES ROAD
 POP UP CYCLING SCHEME
 COVID-19 TEMPORARY MEASURES**

Drawing Title
**EMERGENCY
 TRAFFIC MANAGEMENT ORDER
 SHEET 3 OF 4**

Scale NTS	Date JUN 2020
Drawn By HD	File Ref TM-COVID-POWR-PH1-DD
Checked By YK	Dwg Name TM-COVID-POWR-PH1-DD.dwg

Drawing Location
 T:\Cptl_Schms\2015-16_CN\Chalk Farm ABS\06 - Drawings\05\03 - Detail Design

Drawing Number
 TM-COVID-POWR-PH1-DD-0100-1003

Rev. **A**

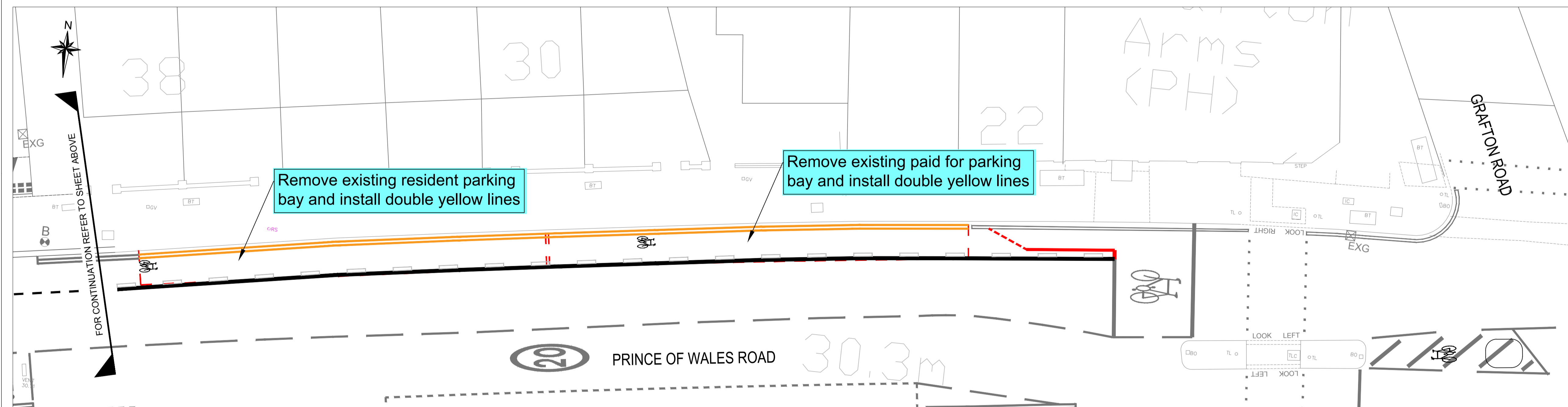
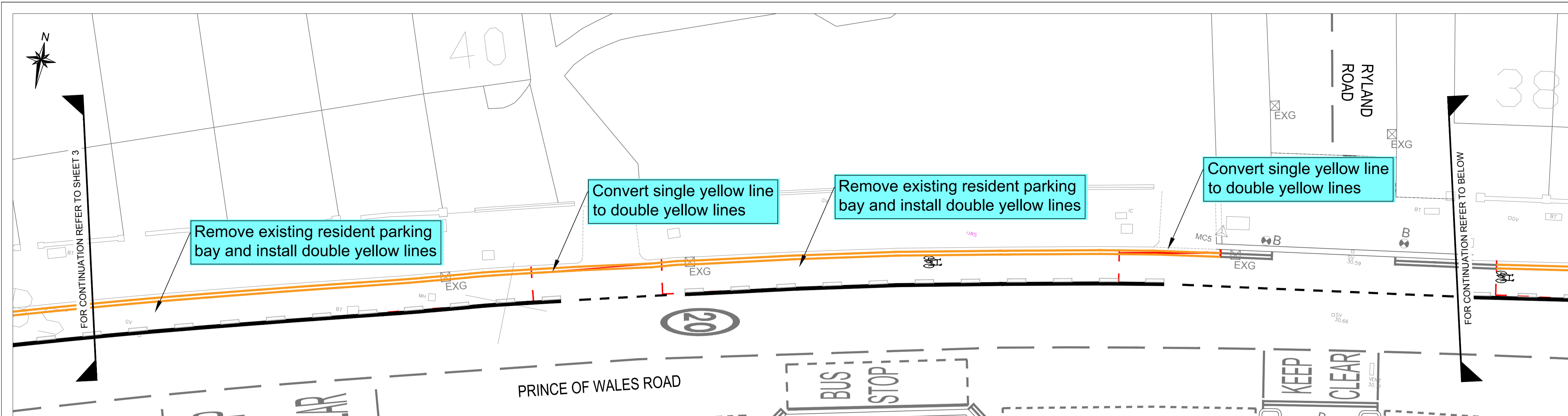

- LEGEND - PROPOSED WORKS**
- TWIN POST BLACK WAND ORCA WITH WHITE REFLECTIVE STRIPS AT 2.5m SPACING
 - NEW SIGN AND NEW POST
 - SIGN TO BE INSTALLED.
 - DOUBLE YELLOW LINE ROAD MARKINGS
 - WHITE ROAD MARKINGS
 - CYCLE LOGO ROAD MARKINGS
 - SETTING OUT LINE
 - SETTING OUT DIMENSIONS

- LEGEND - SITE CLEARANCE WORKS**
- REMOVE EXISTING ROAD MARKINGS

- NOTES**
1. DO NOT SCALE FROM THE DRAWING
 2. ALL DIMENSIONS IN METRES UNLESS STATED OTHERWISE
 3. THE EASTBOUND CYCLE TRACK FROM HAVERSTOCK HILL TO GRAFTON ROAD HAS BEEN COMPLETELY APPROVED, BUT WILL BE CONSTRUCTED IN PHASES.
- THIS IS PHASE 1 WHICH COVERS THE INTRODUCTION OF THE ROAD MARKINGS, SIGNS AND LIGHT SEGREGATION FEATURES IN THE FORM OF WANDS.
- THE OTHER PHASES WILL COVER WORKS TO THE THREE BUS STOP, TWO ZEBRA CROSSINGS AND ONE INFORMAL CROSSING POINT.



Rev	By	Date	Amendments
A	HD	22.06.20	TMO Issue

Camden
 Design Team
 Transport Strategy Service
 London Borough of Camden
 5 Pancras Square
 Tel 020 7974 5551, Fax 020 7974 6952
 DX 2106 Euston, Mincorn 020 7974 6866

PHASE 1

Project
**PRINCE OF WALES ROAD
 POP UP CYCLING SCHEME
 COVID-19 TEMPORARY MEASURES**

Drawing Title
**EMERGENCY
 TRAFFIC MANAGEMENT ORDER
 SHEET 4 OF 4**

Scale NTS	Date JUN 2020
Drawn By HD	File Ref TM-COVID-POWR-PH1-DD
Checked By YK	Dwg Name TM-COVID-POWR-PH1-DD.dwg
Drawing Location T:\Cptl_Schms\2015-16_CN\Chalk Farm ABS\06 - Drawings\05\03 - Detail Design	
Drawing Number TM-COVID-POWR-PH1-DD-0100-1004	Rev. A